

WM-S Small Speaker Wall Mount



- Practical and robust wall mount for speakers up to 33lb (15 kg)
- Variable adjustments both for angle and direction (0-30°)
- Equally suited for: home, object and public venues
- Optional: many adapter plates for a variety of loudspeakers

Please read and follow these instructions carefully. They inform you about all important steps regarding assembly and handling. We recommend that you keep them for future reference.

SAFETY NOTES

- Load bearing weight maximum load 33lb 15 kg
- Only suitable for indoor use
- In case of damage the product may not be used.
- Only use trained technicians to install the system.
- If the product is used at productions or events ALL Trade Association Regulations (BGV C1) (BGI 810, Section 3.2.3) apply.
- Please observe the attached SAFETY DATA SHEET ASSEMBLY ACCESSORIES
- Use 4 screws/anchors for the ceiling mount under observation of the applicable local mounting regulations (they may deviate from the examples presented here).
- Only mount on suitable ceilings with the corresponding assembly materials (not included in the delivery); Example see under Section 2. Observe the placement instructions provided by the anchor manufacturer.
- Ceilings that are too weak or have electrical and water conduits are not suitable.
- In case of doubt consult a qualified technician.
- Ensure that the screws are tight and load-bearing, in particular as regards the setting of the loudspeaker angle.
- Careful and attentive handling is required when adjusting the stand - due to the possibility of pinching or wedging your hand.

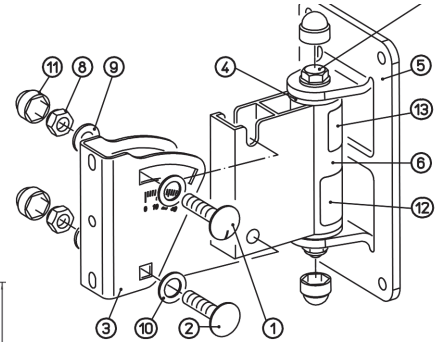
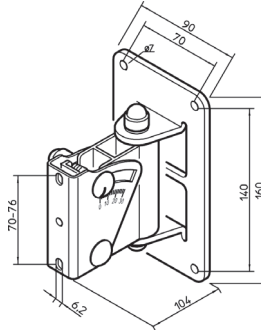

Pos.	Qty.	Description	Dimensions
1	1	Carriage bolt imprinted	M8x40
2	1	Carriage bolt	M8x40
3	1	Swivel bracket	67,3x28,5x2x87
4	2	Damping washer	ø,30x7,9
5	1	Wall mount	90x41,5x190
6	1	Adjustable bracket	78,5x30x80
7	1	Hexagonal bolt	M8x110
8	3	Locking nut	M8
9	4	Washer	ø,17x1,6xø,8,4
10	2	Washer	ø,18xø,11,2x1,2
11	4	Protective cap M8	ø,17x15 SW13
12	1	Sticker TÜV GS	60x30
13	1	Nameplate	25,4x50,8

SETUP INSTRUCTIONS - Install wall mount (1-3)

1 Remove the swivel bracket from the wall mount

2 Install the wall mount

3 Installation examples: A Concrete Wall - Example: Bolt Anchors M6 x 65

Drill, blow out the drill hole, hammer in the anchor, position plate/mount, set washers, tighten nuts

B Perforated bricks - Example: Frame anchors 8 x 80 mm with wood screw 6 x 85 mm

Drill holes, counter sink and blow out drill hole, set the anchor, install the plate/mount, screw in screws

C Injection molded anchors

- WITHOUT Sieve bushing: for solid masonry and concrete
- WITH Sieve bushing: for hollow bricks

- Advantages: Mount without expansion, as such the mount can be used as often as needed, and enables the mount to be close to the edge (at least 100 mm distance)
Please follow the assembly/mounting instructions provided with the products.

SETUP INSTRUCTIONS - Install wall mount (4-6)

4 MOUNT SPEAKERS - DIRECT without adapter plate

4.a
Screw the speakers to the swivel bracket with the included screws and washers.

(Screws may differ according to the respective loudspeaker)

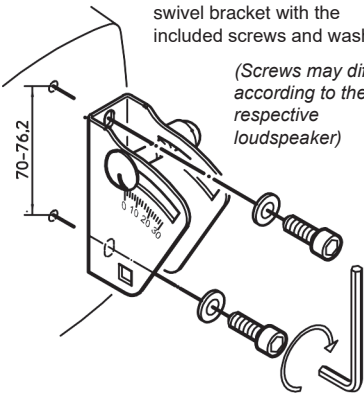

4.b Hang swivel bracket (with mounted loudspeaker) into the wall mount/bracket

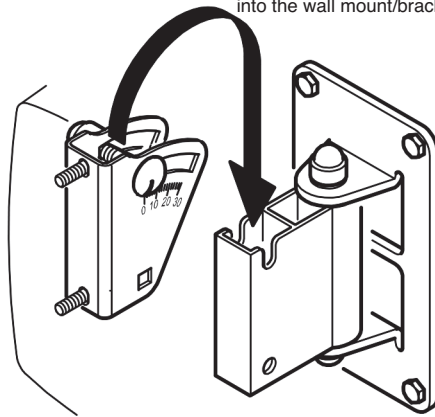

4.c
Secure the swivel bracket that has been hung into the wall mount. Screw the parts together with a carriage bolt, washer and locking nut.

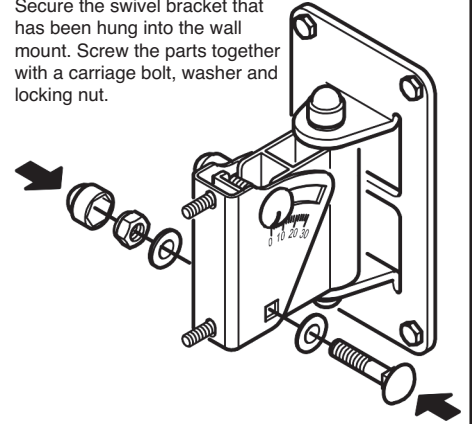

5 MOUNT LOUDSPEAKER with included adapter plate

5.a Adapter plates are needed for the different connection dimensions. The correct adapter plate for your loudspeaker installation has been included and can be found in the table below:

Art. 24352 (Adapterplatte 1) Art. 24354 (AP 2) Art. 24356 (AP 3) Art. 24357 (AP 4) Art. 24358 (AP 5) Art. 24359 (AP 6)

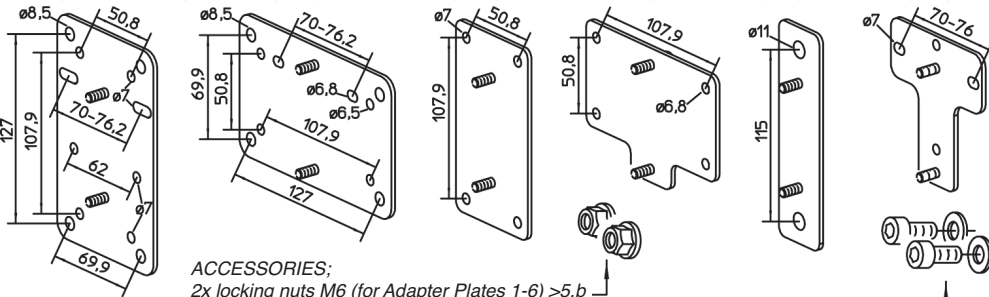

5.b Screw the appropriate adapter plate using both locking nuts on the swivel bracket.

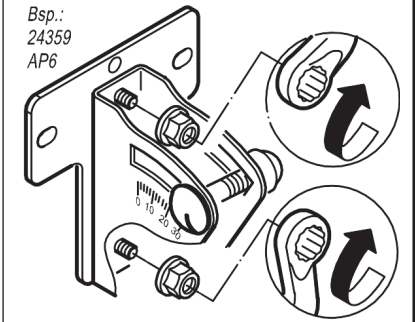

5.c Screw the loudspeaker to the adapter plate with the included screws and washers

(Screws differ according to the respective loudspeaker.)

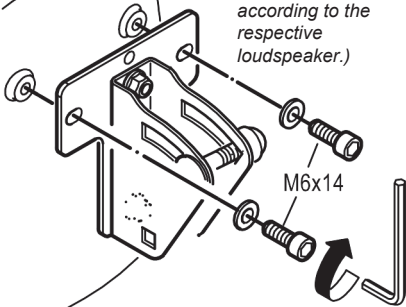

5.d Hang the swivel bracket (with mounted loudspeaker) into the wall mount.

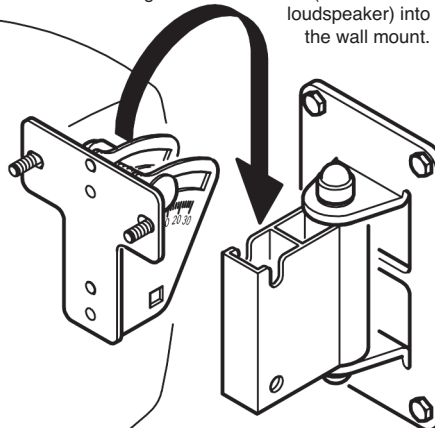

5.e Secure the swivel support arm with a lock screw, washer and locking nut. Place the cap on the bolt.

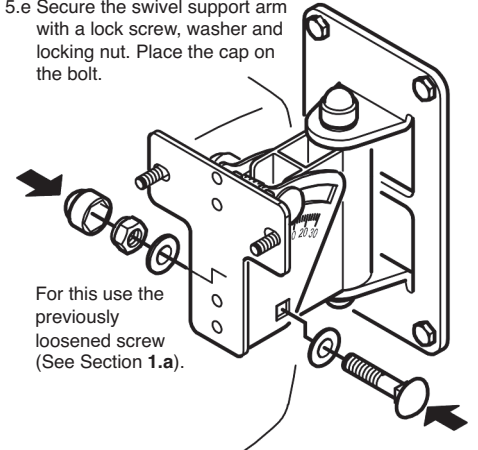

6 SETTINGS

6.a
Variable adjustment from 0° to 30°. Loosen the upper screws and adjust the angle according to the scale. Tighten the screws.

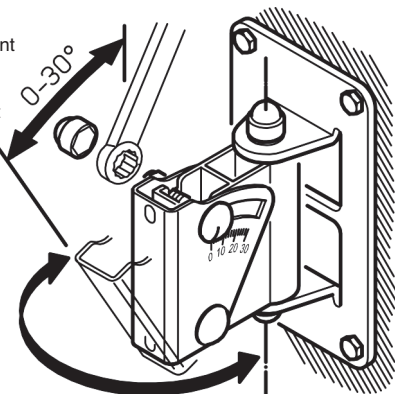

6.b
Variable adjustment around the vertical axis.

CHECK, MAINTENANCE, CLEANING

- In the event of maintenance pay attention to possible risks (wedging, possibility of being knocked into, ladder?)
- To care for the product use a damp cloth and a non-abrasive cleaning agent

FAULT-FINDING (F) and REPAIR (R)

F: The wall mount/bracket is loose

F: The swivel bracket/adapter plate is loose

F: The loudspeaker inadvertently leans forward

R: Check to ensure the wall is suitable (load bearing)

R: Check the screws 3 and tighten/replace (use a qualified technician)

R: Check screws 4.a, 5.c and tighten; Check the loudspeaker case

R: Screw connections (6.a) screws not properly tightened, i.e. tighten screws

TECHNICAL DATA / SPECIFICATIONS

Material	Wall plate, swivel bracket: Steel, powder coating, black Suspension profile: Aluminum, powder coating, black Screws: Steel, galvanized Caps, Cushioning: Plastic (PE, PA)
Load	Loudspeakers: max. 33Lbs 15 kg
Dimensions	W x D x H: 90 x 104 x 160 mm, Box: 110 x 120 x 220 mm
Weight	net: 1.0 Lb 0.9 kg gross: 2.2Lbs 1.0 kg

GENERAL SAFETY AND ASSEMBLY INSTRUCTIONS

MOUNTING ACCESSORIES for overhead installations (e.g. wall, ceiling and truss mounts)

1. General safety instructions

These mounting accessories may only be mounted and used:

- By qualified personnel familiar with the relevant Federal, State, and locality regulations,
- in accordance with local and state regulations and the regulations for occupational insurance schemes
- as described in the assembly instructions (=installation and operating instructions),
- after a fault-free functional and visual inspection (completeness, operational safety; special attention must be paid to deformations, notches, cracks,
- if free of wear, damage to threads; corrosion and legibility of markings),
- without changing or processing the components,
- indoors (not in damp rooms).

2. General installation instructions

- The installation should be carried out by qualified personnel.
- Depending on the nature of the walls/ceilings and the type of load, mechanical fasteners of suitable design and sufficient dimensions must be used.
- In particular, take into account the reduced load-bearing capacity of wall and ceiling coverings, facing plywood and insulation panelling.
- The specified tightening torques must be observed for all screw connections. If nothing is specified, the maximum tightening torques for the respective screw connection apply.

3. Safety measures Cabinet systems must be secured against falling down in the area of stages or studios. A distinction is made between two types of protection:

1. Mobile installation (e.g. flying speakers, installation using C-hooks on trusses, manually detachable fastening elements) requires a second, independently acting safety element on the unit.
2. Stationary mounting allows the second securing element to be dispensed with if the fastening is sufficiently dimensioned and can only be detached with tools plus being protected against self-loosening.
Nevertheless, we recommend using a second securing element, and many localities require this added safety mechanism.

4. Safety factors

Fasteners of loudspeaker cabinets are safety-critical components that can endanger life and health of people in case of failure. Depending on the country in which the article is used, the country-specific standards and guidelines for the sector "loudspeakers" must be observed respectively.

5. Inspection and maintenance

Overhead mounting is highly security relevant and requires an appropriate awareness of the potential danger. A safety inspection of the mounting accessories is essential. If damage and/or malfunctions are found on accessories, the product must not be used again until it has been completely overhauled.

- A visual and functional check must be carried out before initial operation, paying particular attention to any deformations, cracks, wear, corrosion, fault-free functioning and the legibility of markings.
- A regular inspection of fastening and accessory parts is recommended and also mandatory in many countries.
- We recommend an annual visual inspection by qualified personnel be performed and additionally, a detailed inspection by an official expert every four years.
- We urgently recommend keeping an inspection log book for the recurring tests where all accessories are entered together with their data and where they can be audited at any time.